

B

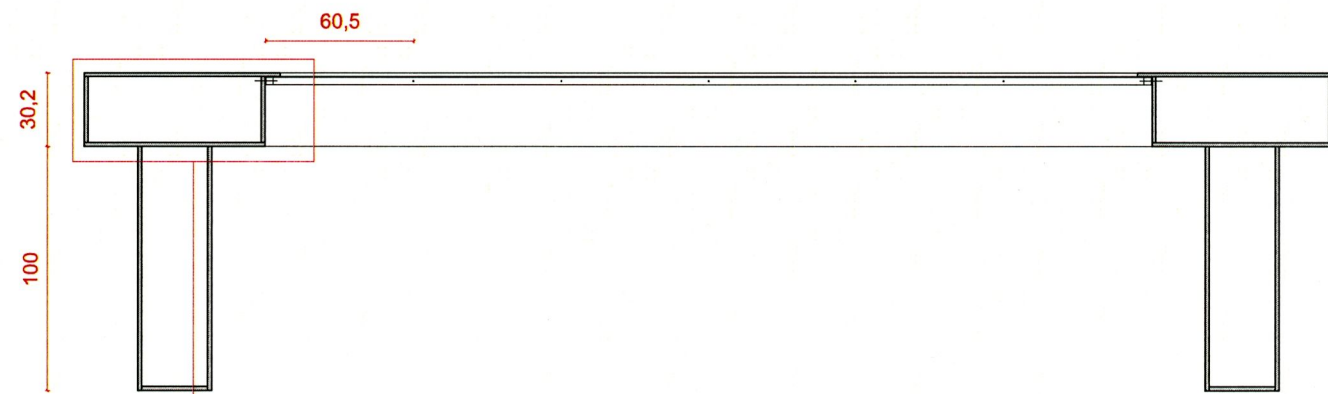

Pantalla fixa PL (desmuntable) , aspecte 16:9, resolució 1024x576 pixels (Otolith II) i 1280x720 pixels (Otolith III).

- 1 - Marc de perfil d'al.lumini de 3X3cm, amb clips frontals.
- 2 - Tela (Retro DL) per retro-projecció, amb vora de 3cm perimetral i clips per tensar al marc.

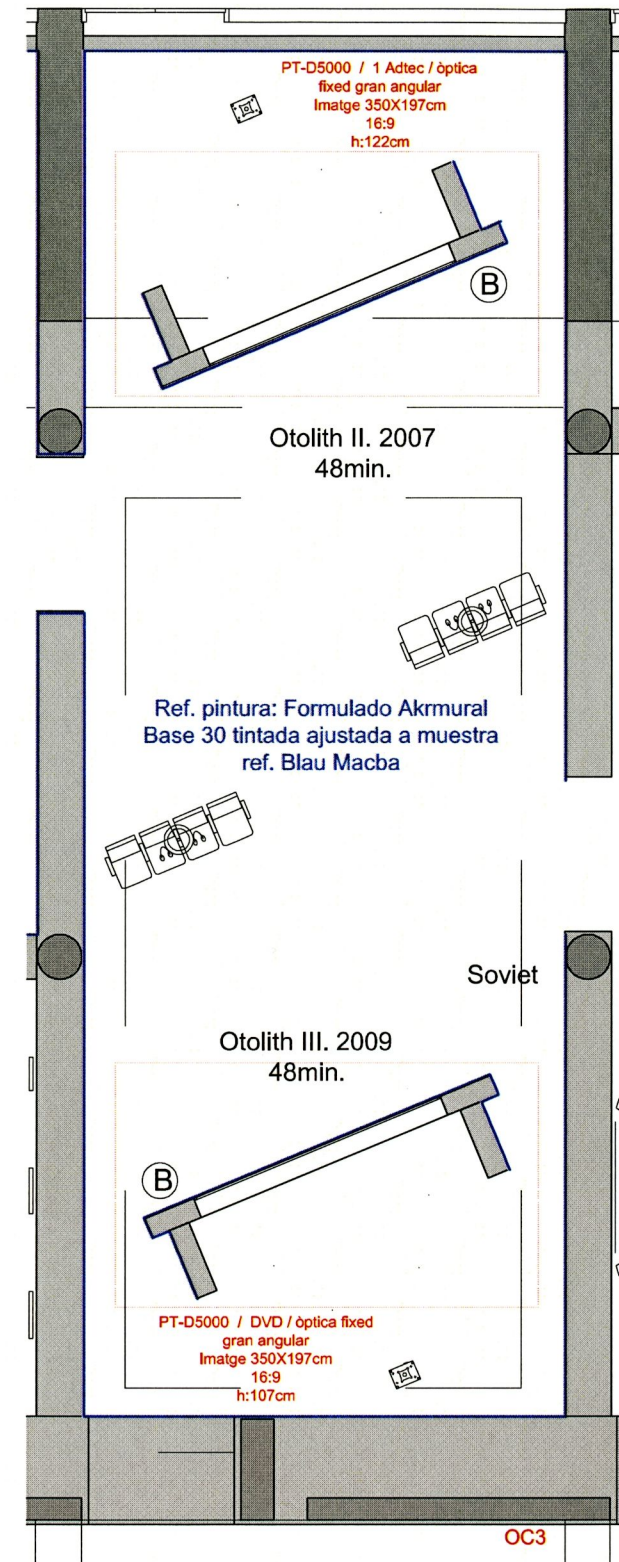
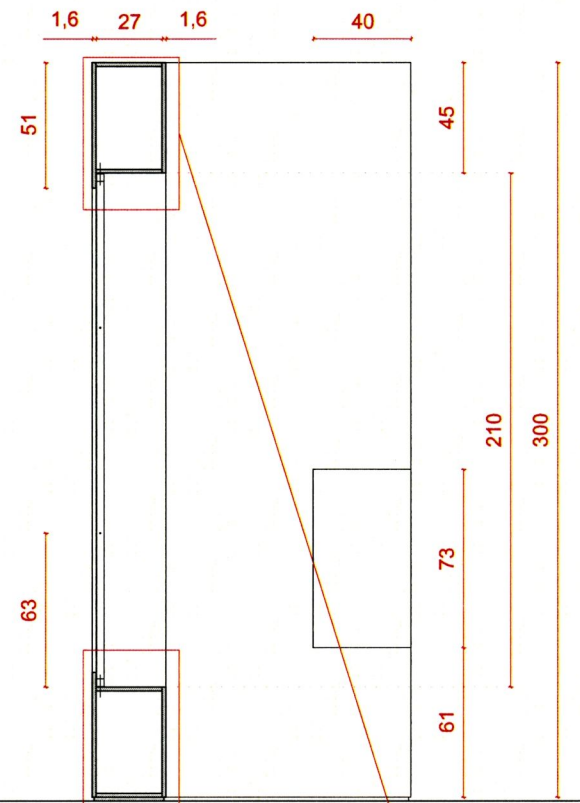
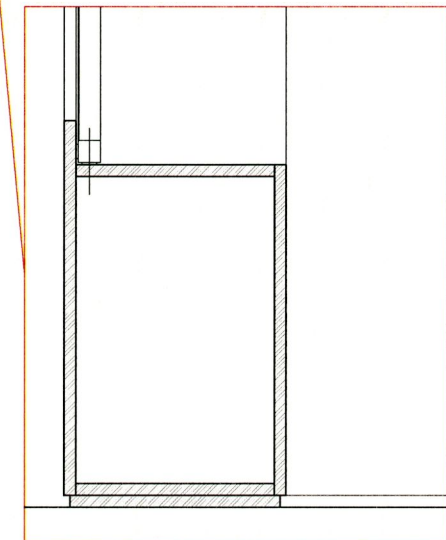
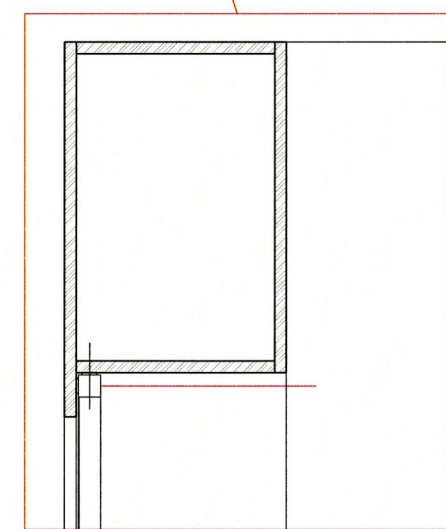
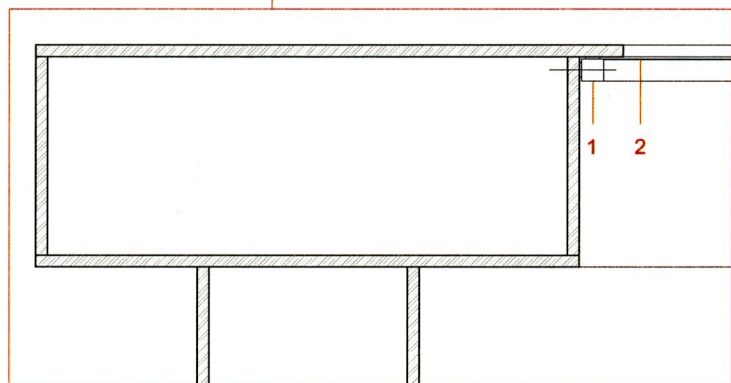

THE OTOLITH GROUP
As built _ OTOLITH II / OTOLITH III

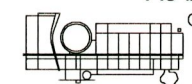

MUSEU D'ART CONTEMPORANI DE BARCELONA

01/06/11
P0